

## RH series

Medium flow intelligent  
high protection peristaltic pump

**OI102RH/OI302RH**



Max flow : 2280mL/min

Max speed : 300rpm

### *Medium flow intelligent high protection peristaltic pump product description*

#### **Product description**

The RH series is a medium-flow intelligent high-protection peristaltic pump with good electromagnetic compatibility. The shell is made of 304 stainless steel, which is durable and corrosion-resistant. It has an IP65 high protection level and is suitable for working in humid and dusty environments. It can be adapted to a variety of pump heads and has two working modes: filling and transmission. It has flow calibration and filling functions to meet the different needs of customers.

#### **Applications**

It can work stably in humid, dusty and severely electromagnetically interfered industrial environments. It is widely used in biopharmaceuticals, chemical production, new energy and other fields.

#### **Product Features**

- LCD display: Color LCD screen displays the operating status in real time, making it easier to use.
- Multiple modes: It has two working modes: filling and transmission.
- 304 stainless steel: The shell is made of 304 stainless steel, which is solid, durable and corrosion-resistant.
- Adaptable to multiple pump heads: Can install YZ, DG, TX series pump heads, etc., and pump heads can be cascaded.
- Anti-electromagnetic interference: Has good electromagnetic compatibility and will not be interfered by the electromagnetic environment.
- IP65 high protection: Protection level reaches IP65, suitable for humid and dusty working environment.
- Filling function: When the specific value of the current required filling volume is unknown, filling can be performed. When the required filling volume is met, the data is saved. Each time the pump is started, the current liquid volume value is used for filling.
- Support external control: Start-stop control, direction control, RS485 communication, speed control (0-5V, 0-10V, 4-20mA, 0-10kHz)

## Technical Parameters

Drive model	OI102RH	OI302RH
Max Speed	100rpm (Reversible)	300rpm (Reversible)
Max Flow	760mL/min	2280mL/min
Speed resolution	0.1rpm	
Display method	Color LCD display (Chinese and English optional)	
Speed mode	Membrane button adjustment	
Back suction angle	0°~720° (0° means no back suction)	
Back suction speed	0-100rpm	0-300rpm
Power	< 50W	
Drive size	248X170X193mm	
Drive weight	4.1kg	
Power supply	AC100-240V, 50Hz/60Hz	
External control interface	Aviation socket	
External control method	Start-stop control, direction control, RS485 communication, speed control (0-5V, 0-10V, 4-20mA, 0-10KHz)	
Ambient temperature	0~40°C	
Protection level	IP65	

## Structural function diagram

Pump head screw → Pump head → Pump head connecting plater → Driver

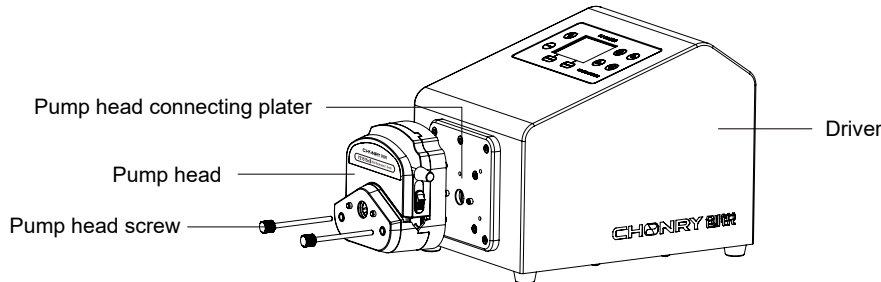

## Dimensional diagram

(unit:mm)

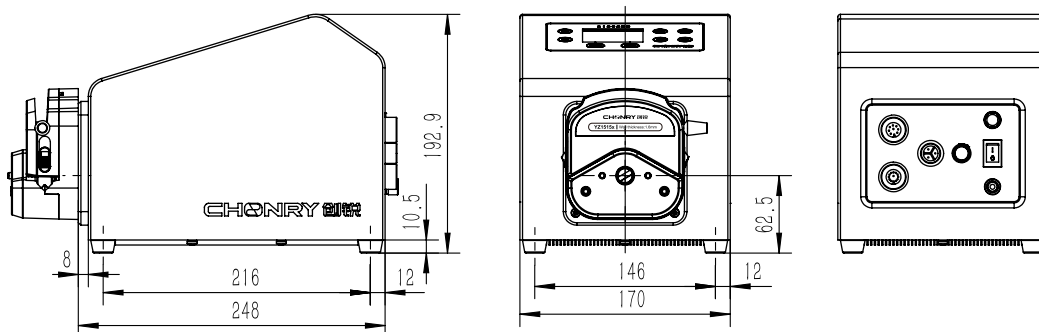

**Baoding Chuangrui Precision Pump Co.,Ltd.**

Address: NO.369 of HuiYang Street , Baoding 071000,Hebei , China

Mobile: +86 15633705132

Website: <http://www.crpump.com>

Email: [support@crpump.com](mailto:support@crpump.com)

