

WP310 series

PRODUCT
DESCRIPTION

OEM peristaltic pump series



WP310 series

PRODUCT DESCRIPTION

OEM Peristaltic Pump

Used in dishwashers, fermentation tanks
environmental protection equipment

Max flow
1100mL/min

Max speed
300rpm

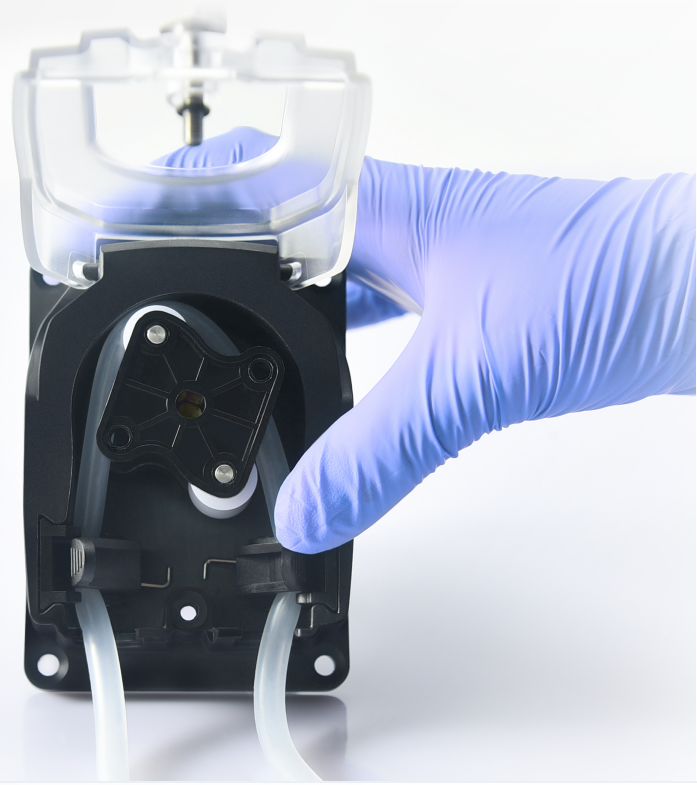

WP310 Series Peristaltic Pump

The pump head is designed with a transparent flip cover and two rollers, which can easily see the working condition of the pump. Suitable for 7 kinds of hoses, matching stepper motor, DC motor, synchronous motor, to meet a variety of scenarios and applications, can provide up to 1100mL/min flow.

Transparent clamshell design

Easy to observe the condition of the hose

The pump head is made of PPS+PC material

Corrosion resistant and high strength

Adaptive spring tube card

Reduce hose wear
Longer life, wider adaptation



Small volume and large flow

Small size, compact structure,
stable transmission

Roller POM material

Excellent heat resistance, wear
resistance and stability

Suitable for various types of hoses and power configurations

Support OEM customization

Pump head parameter table

Hose options: Silicone, PharMed BPT, Neoprene

Pump Head	Channels	Rollers	Max Speed (rpm)	Hose Specifications (Id* Wall Thickness)mm	Max Flow (mL/min)
WP310	1	2	300	13# / 0.8X1.6	1100
				14# / 1.6X1.6	
				19# / 2.4X1.6	
				16# / 3.2X1.6	
				25# / 4.8X1.6	
				17# / 6.4X1.6	
				18# / 7.9X1.6	

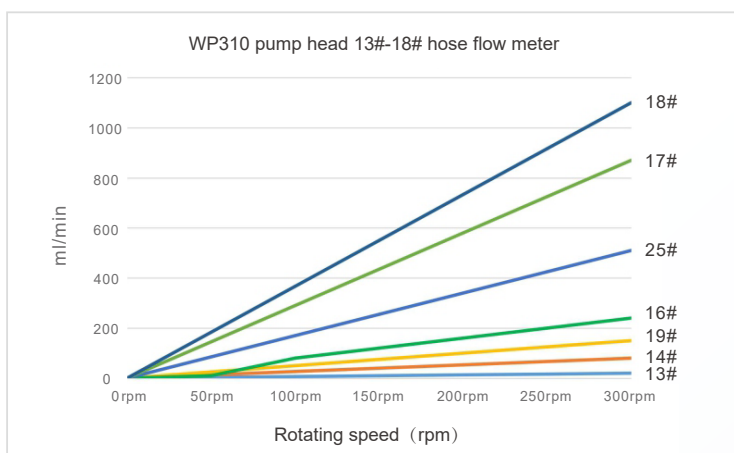

Note: The test environment for flow data is normal temperature and pressure, and the test fluid is water. The values are for reference only, please refer to the actual situation.

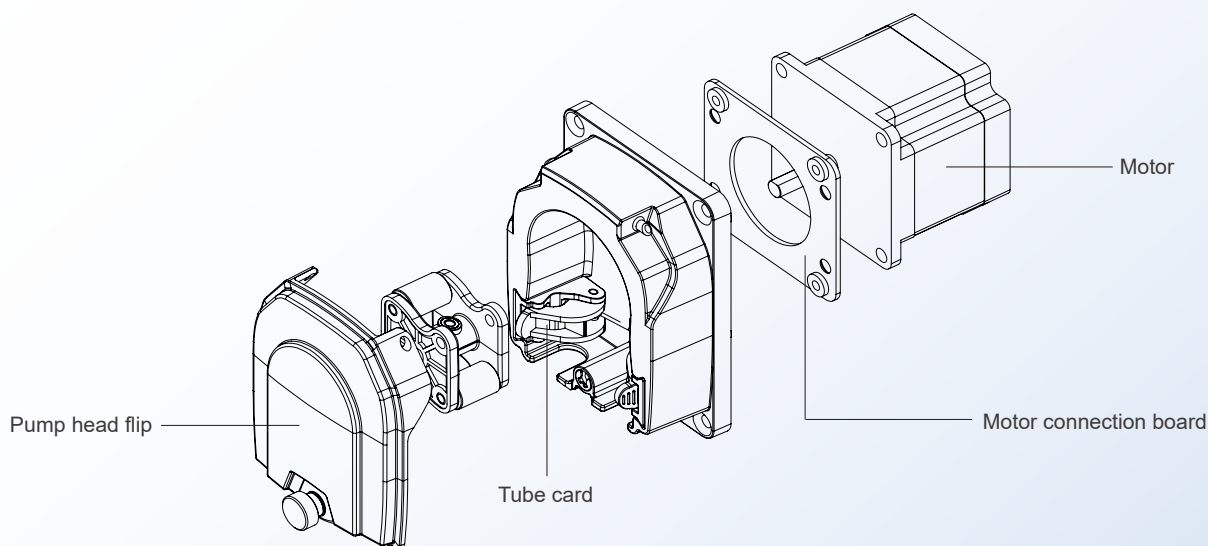

Schematic diagram of structure and function

Pump head → Pump head mounting plate → Motor connection board → Matching motor

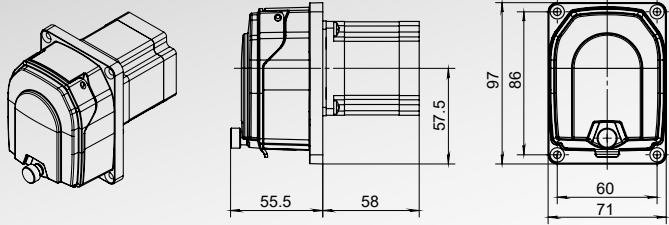
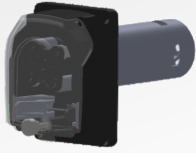
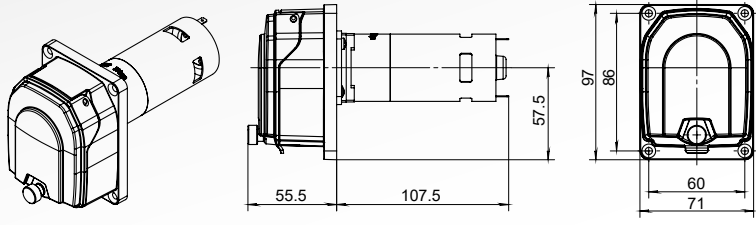

Dimensions

Note: WP310 series can use a variety of motor matching solutions for practical application selection.

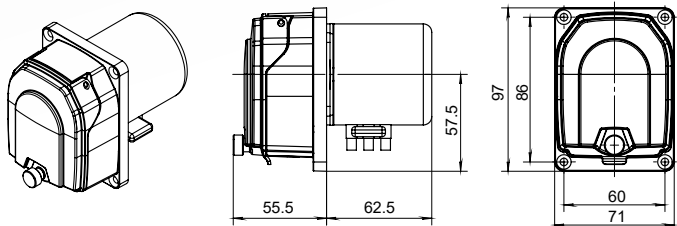
<p>UCP316-A2 (Max flow 1100mL/min)</p> 	 <p>Isometric view, side view, and top view. Dimensions: 55.5, 58, 57.5, 97, 86, 60, 71.</p>
<p>OEM216 (Max flow 1100mL/min)</p> 	 <p>Isometric view, side view, and top view. Dimensions: 55.5, 107.5, 57.5, 97, 86, 60, 71.</p>
<p>ACM116 (Max flow 366mL/min)</p> 	 <p>Isometric view, side view, and top view. Dimensions: 55.5, 62.5, 57.5, 97, 86, 60, 71.</p>

(Unit: mm)

Hose Installation Diagram

- Only touch the inner wall of the hose during fluid transfer, high hygiene level
- Compact structure design, stable transmission performance

Display before installation

- Adaptive tube clips, easy tube loading



Display after installation

- Transparent clamshell design for easy observation

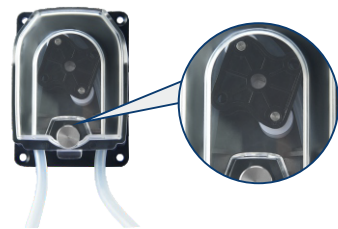

Open the transparent flip cover, press the left self-adaptive tube clip, insert the adaptable hose, turn the roller clockwise, press the other side of the tube into the tube clip, and press down to close the flip cover.

CHONRY 创锐

Baoding Chuangrui Precision Pump Co.,Ltd.

Address: NO.369 of HuiYang Street , Baoding 071000 , Hebei , China

Mobile: +86 15633705132

Website: <http://www.crpump.com>

Email: support@crpump.com

