

# TX215 Series



- Clamshell design, compact and beautiful, easy to change tubes
- With elastic upper pressure block, self-adaptive pipe clamp device, reduce hose wear
- Has good corrosion resistance and ease of use
- Can be matched with 5 types of hoses to meet different flow requirements
- It is a standard supporting product for fermenter equipment and biological scientific research equipment.

Typical Application: Applied to fermenter equipment and biological scientific research equipment

Max Flow: 290mL/min

Max speed : 300rpm

Model	Pump Head	Motor	Voltage	Max Speed	Max Flow(mL/min)				
					13#	14#	19#	16#	25#
OEM217-1	TX215	DC Geard	DC12V	300	10	40	90	140	290
OEM217-2	TX215	DC Geard	DC24V	300	10	40	90	140	290
UCP317-A1	TX215	Stepper		300	10	40	90	140	290
UCP317-B3	TX215	Stepper		300	10	40	90	140	290

Note: The test environment for flow data is normal temperature and pressure, and the test fluid is water. The values are for reference only, please refer to the actual situation.

OEM217 (Max flow 290mL/min)

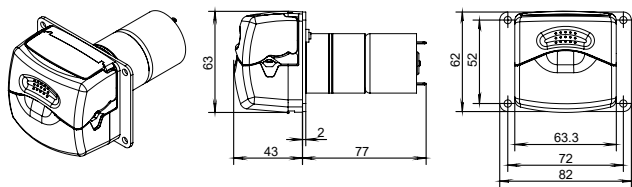

UCP317-A1 (Max flow 290mL/min)

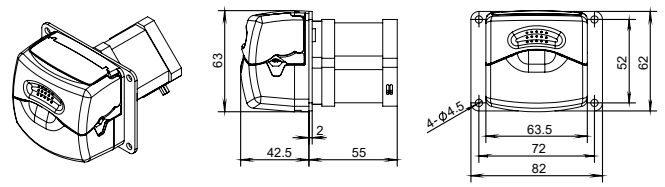

(Unit: mm)